



116 Capitol Square

Church Street, Epsom, KT17 4NR

£1,200 Per Calendar Month



Spacious and modern one double bedroom luxury apartment located in the centre of Epsom in the much sought after Capitol Square development. Please note there is no parking with this property.



Area Map



Floor Plans

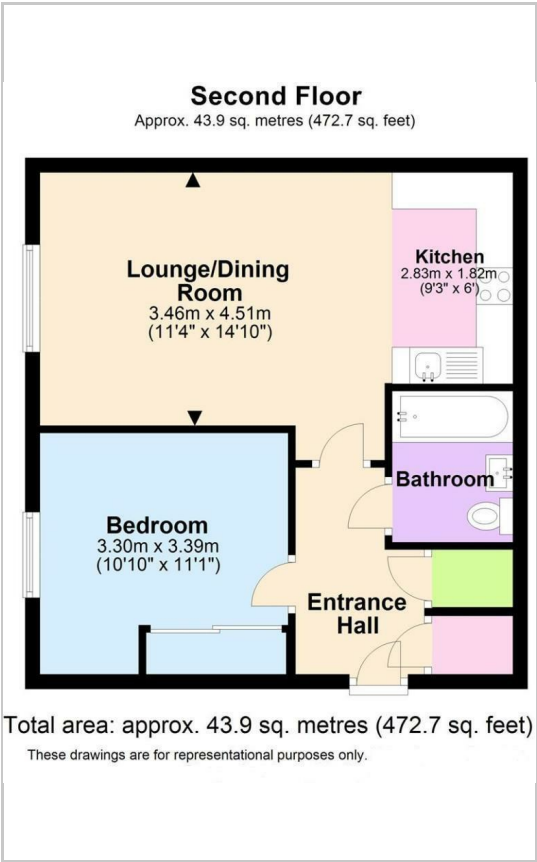

Energy Efficiency Graph

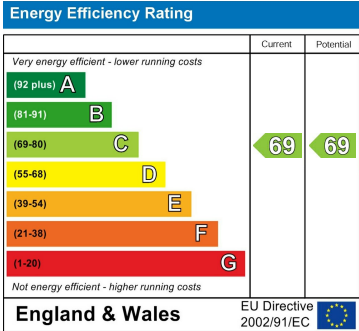

These particulars, whilst believed to be accurate are set out as a general outline only for guidance and do not constitute any part of an offer or contract. Intending purchasers should not rely on them as statements of representation of fact, but must satisfy themselves by inspection or otherwise as to their accuracy. No person in this firms employment has the authority to make or give any representation or warranty in respect of the property.